

Jacklegs shown for reference only.
Check order prior to manufacture.

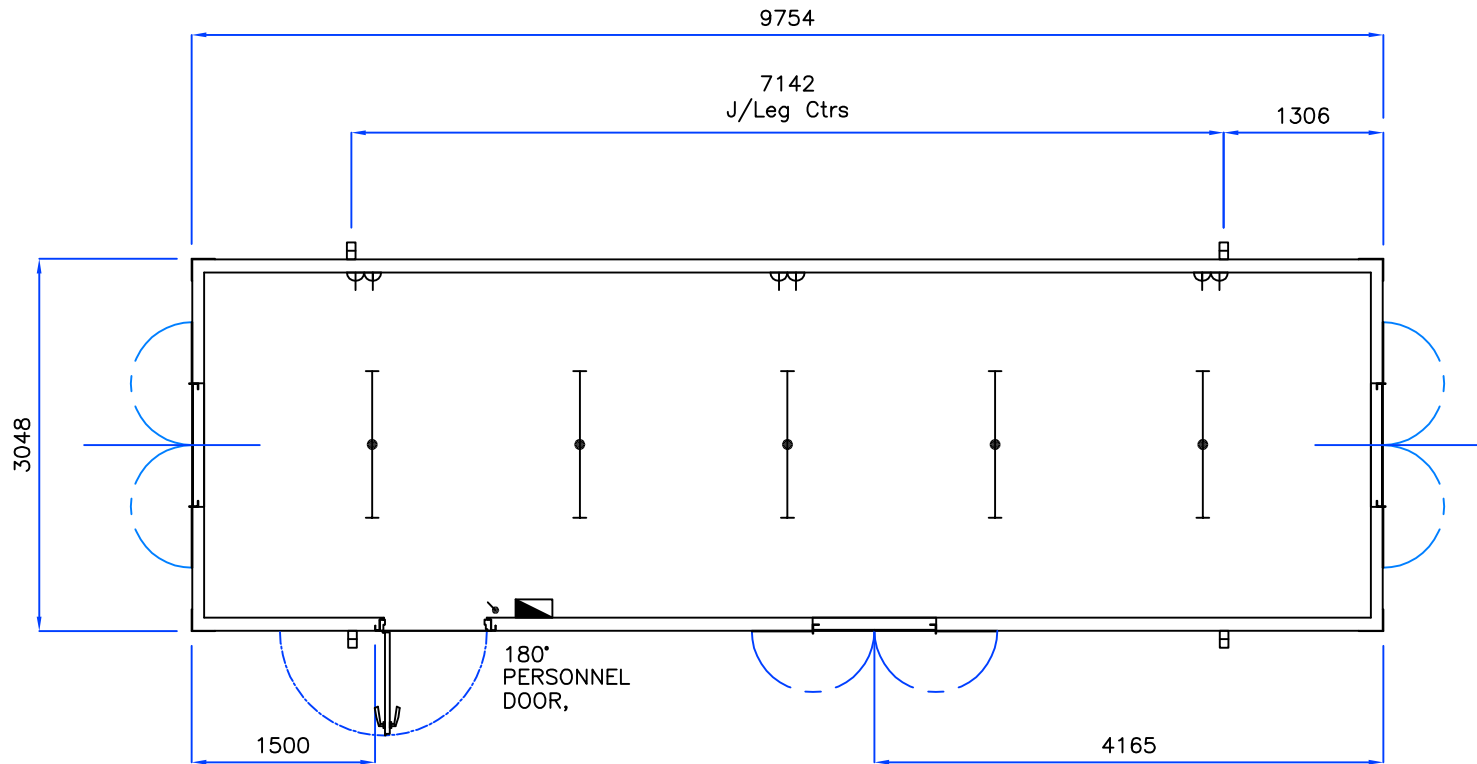

| | |
|--|-------------------------------|
| | Consumer Unit |
| | Light Switch |
| | 4' Fluorescent Light |
| | Twin Skt., 300mm above F.F.L. |
| | Convactor Heater c/w Spur |

APPROVAL BOX

Customer:
Signature:
Name:
Date:

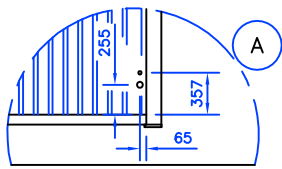

FIXED END ELEVATION

WASTE OUT - ø60mm
WATER IN - ø35mm

LINED USING EGB2001 & INSULATED.
MONO-WHITE CEILING PANELS.
WOODSTAIN TRIM.
'POLYFLOR' FLOORING.

Please Note
3'x3' Single Glazed,
'Ali' Framed Sliding Windows
c/w Secure Steel Shutters

| 1 | 14/5/01 | FIRST ISSUE |
|-------|---------|-------------|
| ISSUE | DATE | DESCRIPTION |

TITLE Termospace
32'x10' Office

| | | | | |
|----------|----|------|---------|---------------------------|
| DRAWN | PB | DATE | 14/5/01 | DRG. No. TER_OP3210V04 |
| APPROVED | | DATE | | |
| CHECKED | | | | |